

LM LIFT MASTER . LIFT MASTER馬達驅動鋼捲夾具 MOTOR DRIVEN COIL LIFTERS

This motorized unit provides an excellent method for handling coils – safely and efficiently . One man can operate the unit either by pendant control from the floor or from a crane cab ,



Using a hoist or crane the lifter is positioned over the coil and lowered until the lifting shoes can clear the I.D. of the coil . The leg movement is then activated and the lifting shoes enter the coil .

As the coil is lifted , a limit switch is location , set down and the legs moved clear .

The curved lifting shoes are designed to minimize the possibility of damage to the inside of the coil .

Electrical : can be furnished for AC power supply with 115 volt transformer or lower voltage for controls as required .

A suitable receptacle is provided for the power cable .

Push button controller , power cable and field wiring are not included in standard pricing

Capacity : can be designed for requirements through 35 Metric tons .

Specify coil O.D. , I.D. with width ranges (min. and max.) and maximum coil weight with inquiry to factory .

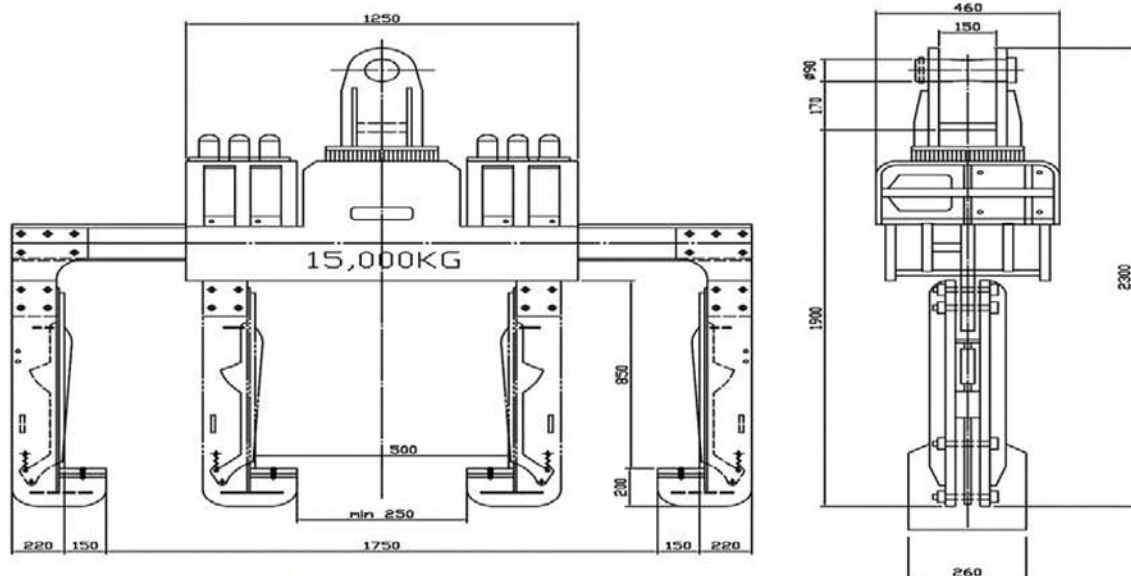

CRANE TECH ENGINEERING CO., LTD.

“C” HOOK COIL LIFTERS THE PREFERRED “C” HOOK



Check these features :
Greater durability

Design flexibility
Lifting bail can be designed to suit .
Dimensions and configuration of the carrying
arm can be varied to suit .
Capacities & sizes to suit .

Economical

Check the crane price before you buy !

Crane “C” hooks are built by compact structure plate , the bail , counterweight , and curved plate designed to the highest safety standards in the industry .

The lower carrying arm is tapered for easy entrance into the ID of the coil , the top edge of the carrying arm is beveled on small sized hooks .

The counterweight is designed and welded to the body of the hook to permit the unit to hang level when empty .

While each hook is designed to handle a certain size coil , smaller coils can be handled provided the center of gravity of the load is positioned directly under the center of the lifting bail – see the B dimension on the sketch on the following page .

Handles for easy movement & location .

Low headroom bail .

Capacities to 35 metric ton

鋼捲夾具相片 1



