



Material Handling Products



HWE WANG ENTERPRISES INC.

M-43-ST, Wire Rope Clips (Stainless Steel)

不鏽鋼鋼索夾

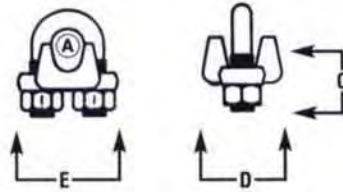

- Standard Material: Forged Type 316 Stainless Steel
- Standard Finish: Electro-polish

For Rope Diameter		Dimensions										Weight Per 100	
A	Cat. No.	UPC No.	B	C		D		E		Clips Per Fastening	lb.	kg.	
in. mm		020418	in. mm	in. mm	in. mm	in. mm	in. mm	in. mm	in. mm				
1/8 3	6403002	094101	5/32 4	9/16 14	3/4 19	3/4 19	3/4 19	3/4 19	3/4 19	2	4	2	
3/16 5	6403003	094118	1/4 6	3/4 19	7/8 22	1 1/8 29	1 1/8 29	1 1/8 29	1 1/8 29	2	10	5	
1/4 6	6403004	094125	5/16 8	1 25	1 1/8 29	1 3/8 35	1 3/8 35	1 3/8 35	1 3/8 35	2	18	8	
3/8 9	6403006	094132	1/2 13	1 3/8 35	1 1/2 38	2 51	2 51	2 51	2 51	2	52	23	
1/2 13	6403008	094149	9/16 14	2 51	1 7/8 48	2 5/16 59	2 5/16 59	2 5/16 59	2 5/16 59	3	89	40	

Fittings

Shackles

卸克

- | | | |
|---------------------------|----------------------------|----------------------------|
| 416-S Round Pin Chain | 999-G, A Safety Anchor | Stainless Screw Pin Anchor |
| 419-S, G Screw Pin Anchor | 998-G Safety Chain | Stainless Safety Anchor |
| 422-G Screw Pin Chain | Stainless Round Pin Anchor | |

READ AND UNDERSTAND THESE WARNINGS AND INSTRUCTIONS BEFORE USING SHACKLES.



ROUND PIN ANCHOR SHACKLE



SCREW PIN ANCHOR SHACKLE

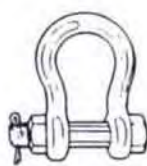

SAFETY ANCHOR SHACKLE



ROUND PIN CHAIN SHACKLE

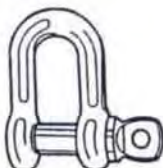

SCREW PIN CHAIN SHACKLE

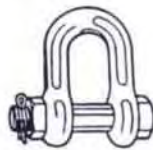

SAFETY CHAIN SHACKLE

WARNING

- Failure to follow the Instructions For Use below and these warnings may cause death or serious injury.
- Use shackles only as indicated.
- Shackles must always be inspected for wear, distortion and damage before use. If the pin or bow is worn, distorted or damaged, discard the entire shackle and replace.
- Do not use round pin shackles in rigging applications.
- Screw pin shackles should not be used if there will be movement on the pin. Movement could cause the pin to unscrew and drop the load.
- Always stand clear of loads being lifted.



Anchor Shackles – Bolt Type (Imported) Type 316 Stainless Steel

不鏽鋼葫蘆卸克附螺帽

- Standard Material: Forged Type 316 Stainless Steel
- Standard Finish: Electro-polish
- Imported

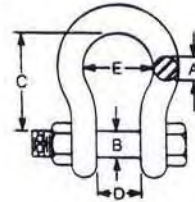

Size	Cat. No.	UPC No.	Working Load Limit		Tolerances			Dimensions								Weight Each			
			lb	kg	Length	Width	B	C	D	E	F	lb	kg						
in.	mm	020418			±in. ±mm	±in. ±mm	in.	mm	in.	mm	in.	mm	in.	mm	in.	mm			
5/16	8	6402405	093852	1300	590	1/16 2	1/16 2	3/8	10	1 1/4	32	1 7/32	13	2 7/32	21	3/4	19	0.16	0.07
3/8	9	6402406	093869	1500	681	1/8 3	1/16 2	7/16	11	1 7/16	37	2 1/32	17	3 1/32	25	15/16	24	0.20	0.09
7/16	11	6402407	093876	2000	907	1/8 3	1/16 2	1/2	13	1 3/4	44	2 3/32	18	1 5/32	29	1 1/8	29	0.50	0.23
1/2	13	6402408	093883	3000	1362	1/8 3	1/16 2	5/8	16	1 15/16	49	1 3/16	21	1 1/4	32	1 1/4	32	0.72	0.33
5/8	16	6402410	093890	4000	1814	1/8 3	1/16 2	3/4	19	2 7/16	62	1 1/16	27	1 9/16	40	1 7/16	37	1.38	0.63
3/4	19	6402412	093906	6000	2722	1/4 6	1/16 2	7/8	22	2 13/16	71	1 1/4	32	1 13/16	46	1 3/4	44	2.22	1.01
7/8	22	6402414	093913	8000	3629	1/4 6	1/16 2	1	25	3 1/4	63	1 7/16	37	1 13/16	46	1 3/4	44	2.22	1.01
1	25	6402416	093920	10000	4540	1/4 6	1/16 2	1 1/8	29	3 3/4	95	1 11/16	43	2 1/8	54	2	51	3.28	1.49

⚠️ ADVERTENCIA

Para prevenir la posibilidad de lesiones graves:

- **NO EXCEDA** el límite de carga de trabajo (WLL).
- **NO LA UTILICE** choque o golpee la carga.
- **NO USE** el accesorio si se ve deformado o desgastado.

⚠️ WARNING

To prevent the possibility of serious bodily injury:

- **DO NOT EXCEED** the working load limit.
- **DO NOT** shock or impact load.
- **DO NOT USE** if the fitting is visibly distorted or worn.



Anchor Shackles – Screw Pin (Imported)

葫蘆型卸克-螺栓插梢型(螺絲插梢型)

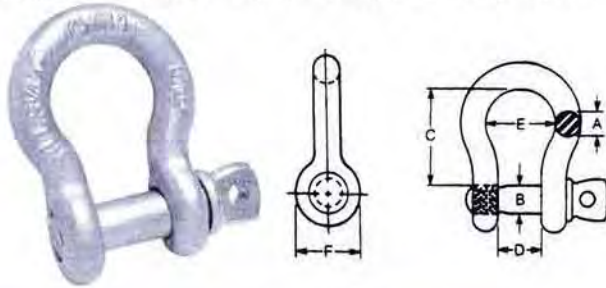

- Industrial grade
- Forged steel
- Galvanized
- Design factor: 5 to 1
- Working Load Limit shown on every shackle
- UPC tagged

Size in. mm	Cat. No.	UPC No. 020418	Working Load Limit		Dimensions												Case Weight				
			Tons	kg	A in. mm	B in. mm	C in. mm	D in. mm	E in. mm	F in. mm	Shelf Pack	Case Pack	lb	kg							
3/16	6	T9640335	211706	1/8	302	0.19	5	0.25	6	0.87	22	0.37	9	0.63	16	0.56	14	10	100	6	3
1/4	7	T9640435	211683	1/2	454	0.25	6	0.31	8	1.12	28	0.50	13	0.78	20	0.69	18	10	100	11	5
5/16	8	T9640535	211676	3/4	680	0.32	8	0.37	9	1.20	30	0.54	14	0.83	21	0.86	22	10	100	18	8
3/8	10	T9640635	211669	1	907	0.38	10	0.43	11	1.44	37	0.67	17	1.00	25	1.05	27	10	100	32	14
1/2	13	T9640835	211652	2	1814	0.50	13	0.62	16	1.86	47	0.86	22	1.30	33	1.20	30	5	50	35	16
5/8	16	T9641035	211645	3 1/4	2948	0.62	16	0.75	19	2.44	62	1.06	27	1.56	40	1.44	37	1	25	38	17
3/4	20	T9641235	211621	4 3/4	4309	0.75	19	0.87	22	2.80	71	1.30	33	2.00	51	1.85	47	1	15	35	16
7/8	22	T9641435	211638	6 1/2	5897	0.87	22	1.00	25	3.20	81	1.43	36	2.15	55	2.00	51	1	10	34	15
1	26	T9641635	211614	8 1/2	7711	1.00	25	1.12	28	3.75	95	1.68	43	2.55	65	2.37	60	1	5	26	12

Anchor Shackles – Screw Pin Type 316 Stainless Steel

不鏽鋼葫蘆卸克(直接鎖入)

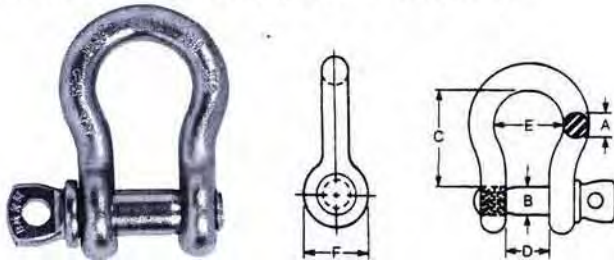

- Forged Type 316 Stainless Steel
- Electro-polished finish
- Imported

Size in. mm	Cat. No.	UPC No. 020418	Working Load Limit		Tolerances		Dimensions										Weight Each				
			lb	kg	Length ±in. ±mm	Width ±in. ±mm	B in. mm	C in. mm	D in. mm		E in. mm		F in. mm		lb	kg					
1/4	6	6402104	093654	1000	454	1/16	2	1/16	2	5/16	8	1 1/8	29	1/2	13	3/4	19	1 1/16	17	0.10	0
5/16	8	6402105	093661	1300	590	1/16	2	1/16	2	3/8	10	1 1/4	32	17/32	13	27/32	21	3/4	19	0.16	0
3/8	10	6402106	093678	1500	681	1/8	3	1/16	2	7/16	11	1 7/16	37	21/32	17	31/32	25	15/16	24	0.20	0
7/16	11	6402107	093685	2000	907	1/8	3	1/16	2	1/2	13	1 3/4	44	23/32	18	1 5/32	29	1 1/8	29	0.50	0
1/2	13	6402108	093692	3000	1362	1/8	3	1/16	2	5/8	16	1 15/16	49	13/16	21	1 1/4	32	1 1/4	32	0.72	0
5/8	16	6402110	093708	4000	1814	1/8	3	1/16	2	3/4	19	2 7/16	62	1 1/16	27	1 9/16	40	1 7/16	37	1.30	1
3/4	19	6402112	093715	6000	2722	1/4	6	1/16	2	7/8	22	2 13/16	71	1 1/4	32	1 13/16	46	1 3/4	44	2.22	1
7/8	22	6402114	093722	8000	3629	1/4	6	1/16	2	1	25	3 1/8	79	1 7/16	37	2 1/8	54	2	51	3.28	1

⚠️ ADVERTENCIA

Para prevenir la posibilidad de lesiones graves:
 • **NO EXCEDA** el límite de carga de trabajo (WLL).
 • **NO LA UTILICE** choque o golpee la carga.
 • **NO USE** el accesorio si se ve deformado o desgastado.

⚠️ WARNING

To prevent the possibility of serious bodily injury:
 • **DO NOT EXCEED** the working load limit.
 • **DO NOT** shock or impact load.
 • **DO NOT USE** if the fitting is visibly distorted or worn.



Lifting Eyes, M-41-ST Drop-forged Type 316 Stainless Steel

鍛造316不鏽鋼吊眼

- Standard Material: Forged Type 316 Stainless Steel
- Standard Finish: Electro-polish

Size No.	Cat. No.	UPC No. 020418	Working Load Limit		Weight Each	
			lb	kg	lb	kg
5	6407104	095320	2150	975	.25	.11
6	6407105	095337	3440	1560	.66	.30
7	6407106	095344	5140	2332	.86	.39
9	6407107	095351	9370	4250	1.82	.83

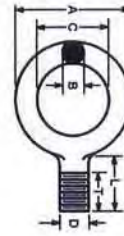

Size No.	D		L		A		C		B		T	
	in.	mm	in.	mm	in.	mm	in.	mm	in.	mm	in.	mm
5	1/2	13	3/4	19	2	50	1	25	1/2	13	5/8	16
6	5/8	16	1	25	2 1/2	64	1 1/4	32	5/8	16	3/4	19
7	3/4	19	1	25	2 13/16	71	1 1/2	38	2 1/32	17	7/8	22
9	1	25	1 7/16	37	3 9/16	90	1 13/16	46	7/8	22	1 1/16	27

Eye Nuts, 776-G Drop-forged Carbon Steel, Normalized

吊帽鍛造碳鋼

- Standard Material: Drop-forged carbon steel normalized
- Standard Finish: Galvanized to ASTM A-153 specification
- Design Factor: 5 to 1

Size No.	Cat. No.	UPC No. 020418	Working Load Limit		Tap Size M UNC-2B		Weight/100	
			lb	kg	in.	mm	lb	kg
1A	7100102	100413	850	386	5/16	8	8	4
2	7100103	100420	1250	567	3/8	10	13	6
3	7100104	100437	1650	748	7/16	11	25	11
3A	7100105	100444	2250	1021	1/2	13	25	11
4	7100106	100451	3600	1633	5/8	16	55	25
5	7100107	100468	5200	2359	3/4	19	113	51
6	7100108	100475	7200	3266	7/8	22	153	69
7	7100109	100482	10000	4536	1	25	275	125
8	7100111	100505	15200	6895	1 1/4	32	363	165
10	7100112	100512	21400	9707	1 1/2	38	656	298

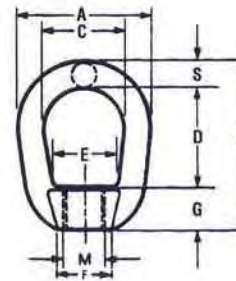

Size No.	A		C		D		E		F		G		S		T	
	in.	mm	in.	mm	in.	mm	in.	mm	in.	mm	in.	mm	in.	mm	in.	mm
1A	1 1/4	32	3/4	19	1 1/16	27	1 9/32	15	1/2	13	1 1/32	9	1/4	6	1 2 1/2	42
2	1 5/8	41	1	25	1 17/64	32	3/4	19	9/16	14	1 5/32	12	5/16	8	2 3/64	52
3	2	51	1 1/4	32	1 1/2	38	1	25	1 3/16	21	1 9/32	15	3/8	10	2 15/32	63
3A	2	51	1 1/4	32	1 1/2	38	1	25	1 3/16	21	1 9/32	15	3/8	10	2 15/32	63
4	2 1/2	64	1 1/2	38	2 1/32	51	1 3/16	30	1	25	3/4	19	1/2	13	3 9/32	83
5	3	76	1 3/4	44	2 7/16	62	1 7/16	36	1 1/4	32	7/8	22	5/8	16	3 15/16	100
6	3 1/2	89	2	51	2 9/16	65	1 5/8	41	1 3/8	35	1	25	3/4	19	4 5/16	110
7	4	100	2 1/4	56	3 1/16	75	1 15/16	48	1 5/8	41	1 1/4	32	7/8	22	5 3/16	130
8	4 1/2	114	2 1/2	64	3 1/2	89	2 1/8	54	1 13/16	46	1 5/16	33	1	25	5 13/16	148
10	5 5/8	143	3 5/8	79	4 1/16	103	2 1/2	64	2 1/4	57	1 1/2	38	1 1/4	32	6 13/16	173

ADVERTENCIA

Para prevenir la posibilidad de lesiones graves:

- NO EXCEDA el límite de carga de trabajo (WLL).
- NO LA UTILICE choque o golpee la carga.
- NO USE el accesorio si se ve deformado o desgastado.

WARNING

To prevent the possibility of serious bodily injury:

- DO NOT EXCEED the working load limit.
- DO NOT shock or impact load.
- DO NOT USE if the fitting is visibly distorted or worn.

Fittings



Jaw & Jaw Turnbuckles, M-16-ST Drop-forged typr316 tainless Steel

鍛造316不鏽鋼伸縮器

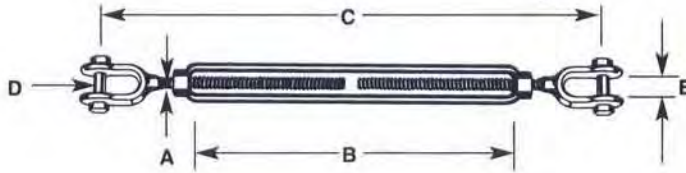

- Standard Material: Forged Type 316 Stainless Steel
- Standard Finish: Electro-polish

Cat. No.	UPC No.	Dimensions				(Closed Position) Length (C)		Pin Dia. (D)		Jaw Opening (E)		Weight Each		Working Load Limit	
		Size (A)		Take Up (B)		in.	mm	in.	mm	in.	mm	lb	kg	lb	kg
6401203	093456	3/8	10	6	152	10 3/4	273	5/16	8	9/16	14	3/4	0.3	1200	545
6401204	093463	1/2	13	6	152	12	305	3/8	9	5/8	16	1 1/2	0.7	2200	999
6401210	093487	3/4	19	6	152	15 1/2	394	5/8	16	1	25	5	2.2	5200	2361

Jaw & Eye Turnbuckles, 786-G Drop-forged Carbon Steel

鍛造開口對眼碳鋼伸縮器



- See Figure 780-G for eye dimensions
- See Figure 788-G for jaw dimensions
- Drop-forged Carbon Steel
- Galvanized to ASTM A-153 specifications
- Design factor 5 to 1

Cat. No.	UPC No.	Working Load Limit		Thread Dia. (A)		Dimensions Take Up (B)		(Closed Position) Length (W)		Weight/100	
		lb	kg	in.	mm	in.	mm	in.	mm	lb	kg
6250401	087387	500	227	1/4	6	4	102	7 7/8	200	33	15
6250402	087394	800	363	5/16	8	4 1/2	114	9 3/8	238	48	22
6250403	087400	1200	544	3/8	10	6	152	11 9/16	294	90	41
6250405	087417	2200	998	1/2	13	6	152	13 1/8	333	164	74
6250406	087424	2200	998	1/2	13	9	229	16 1/8	410	208	94
6250407	087431	2200	998	1/2	13	12	305	19 1/8	486	257	117
6250409	087448	3500	1588	5/8	16	6	152	14 7/8	378	265	120
6250411	087462	3500	1588	5/8	16	12	305	20 13/16	529	380	173
6250422	087561	10000	4536	1	25	12	305	26	660	1206	548
6250427	087592	15200	6895	1 1/4	32	12	305	28 9/16	725	1980	899

⚠ ADVERTENCIA

Para prevenir la posibilidad de lesiones graves:
 • NO EXCEDA el límite de carga de trabajo (WLL).
 • NO LA UTILICE choque o golpee la carga.
 • NO USE el accesorio si se ve deformado o desgastado.

⚠ WARNING

To prevent the possibility of serious bodily injury:
 • DO NOT EXCEED the working load limit.
 • DO NOT shock or impact load.
 • DO NOT USE if the fitting is visibly distorted or worn.

